

K KONTEK
COMATEL



ELECTRONIQUE CONNECTORS MANUFACTURING



AA2DE

Au cœur de la connectique



France

AA2DE

3, RUE CHATLES BEAUVAIS

ZAC DE LA FOSSE AUX MOINES

94864 BONNEUIL SUR MARNE

Commercial France

Tel : 00 33 1 56 71 26 55

Fax : 00 33 1 43 77 52

E-mail : aa2de@club-internet.fr

PRÉFACE



Concevoir et fabriquer des connecteurs parfaitement adaptés aux attentes de ses clients et répondants aux normes : tel est le métier d'AA2DE.

Un métier basé sur un savoir-faire unique acquis depuis des années par son expérience des marchés de l'Automobile, des télécommunications et de l'Electroménager en Europe mais aussi dans le Monde.

S'appuyer sur ses compétences technologiques mais avant tout sur la motivation de ses équipes : telle est la réponse d'AA2DE face aux nouveaux enjeux de la connectique.

Tous nos produits sont conformes à la directive 2002/95/EG du parlement européen et du conseil du 27 janvier 2003 (**RoHS**)

Mr BENTAYB
Directeur Général.



TURNED CONNECTORS AND TERMINALS

Note:

PLATING standard version

Gold 0.25 μm
Gold Flash
Tin

PLATING upon request

Selective Gold Flash
Selective Gold

Packing standard version

Box
Tube

Packing upon request

T&R
T&R + Cap
Tube + Cap



Product Code

A	B	C	D	E
xxxxxxx	1xx	5x0		

A	Version, see table
B	Number of pins max
C	Plating 0 Gold 0.2 µm over Ni 1.27 µm 4 Tin 4 µm over Ni 1.27 µm

Version	P	nn		Plating	
		(a)	(b)	(a)	(b)
331 1594	1	20	500	Au	
332 1594	1	20	540	Sn	
333 1594	1	20	500	Au	
334 1594	1	20	540	Sn	
331 0299	1	20	500	Au	
332 0299	1	20	540	Sn	
331 0300	1	20	500	Au	
332 0300	1	20	540	Sn	

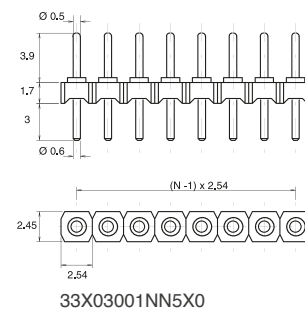
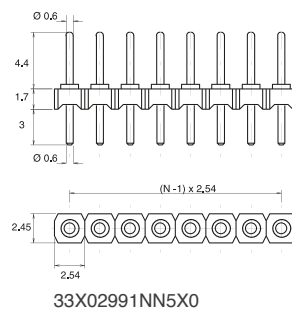
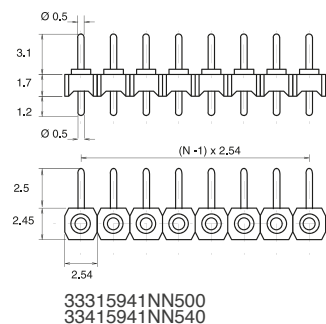
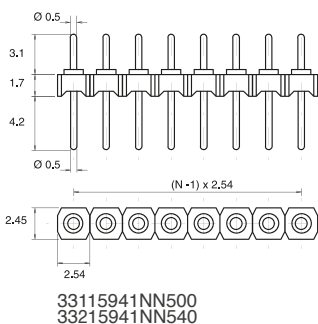

Version	P	nn		Plating	
		(a)	(b)	(a)	(b)
331 0219	1	20	500	Au	
332 0219	1	20	540	Sn	
331 0778	1	20	500	Au	
332 0778	1	20	540	Sn	
330 1940	1	20	500	Au	
330 1940	1	20	540	Sn	
331 0416	1	20	500	Au	
332 0416	1	20	540	Sn	

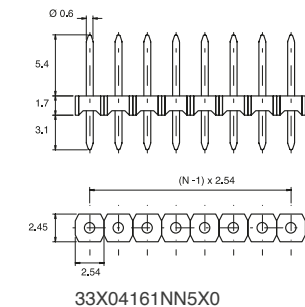
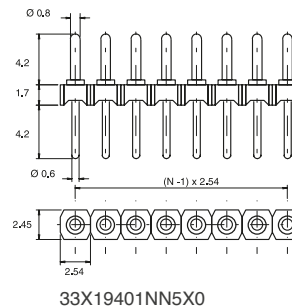
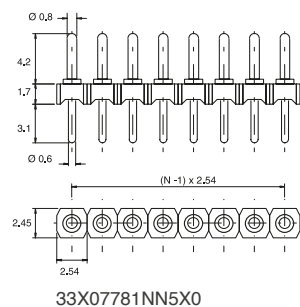
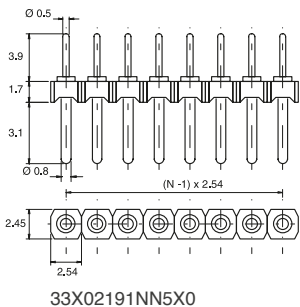

“U” PINS STRIP

STRIP TERMINALS “U”PINS COMPONENT SUPPORT STRIP



Version	P	nn	Plating	
			(a)	(b)
3310815	1	20	500	Au
3320815	1	20	540	Sn
3310809	1	20	500	Au
3320809	1	20	540	Sn
3310600	1	20	500	Au
3320600	1	20	540	Sn
3310600	*P	20	500	Au
3320600	*P	20	540	Sn

Product Code

A	B	C
xxxxxxx	1xx	5x0

A Version, see table

B Number of pins max

C Plating
 0 Gold
 0.2 μm over Ni 1.27 μm
 4 Tin
 4 μm over Ni 1.27 μm

P	1	2	3	4
Pitch	2.54	5.08	7.62	10.16
P	5	6	7	8
Pitch	12.7	15.24	17.78	20.32

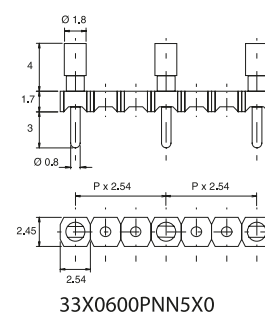
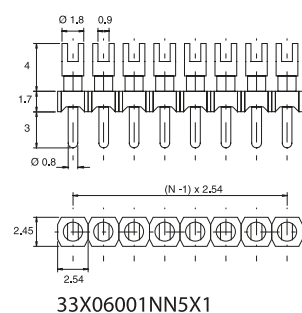
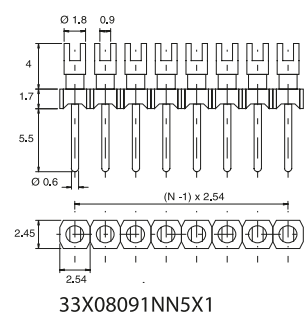
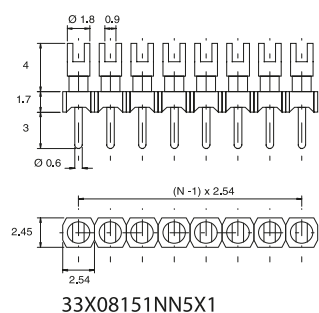

“U” PINS STRIP

STRIP TERMINALS “U”PINS COMPONENT SUPPORT STRIP



Version	P	nn	Plating	
			(a)	(b)
331 0902	2	20	500	Au
332 0902	2	20	540	Sn
333 0902	2	20	500	Au
334 0902	2	20	540	Sn
332 1422	1	20	541	Sn
331 1422	1	20	541	Sn

Product Code

A	B	C
xxxxxxx	1xx	5x0

A Version, see table

B Number of pins max

C Plating
 0 Gold
 0.2 μm over Ni 1.27 μm
 4 Tin
 4 μm over Ni 1.27 μm

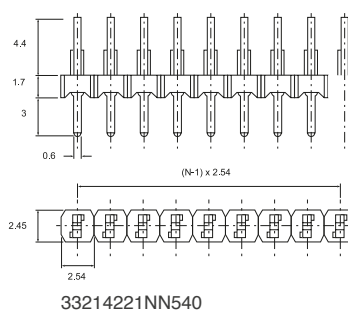
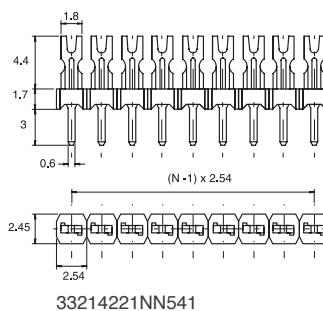
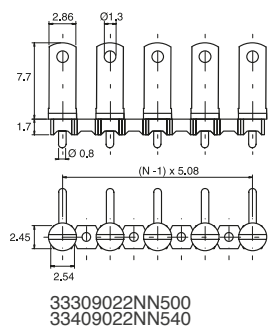
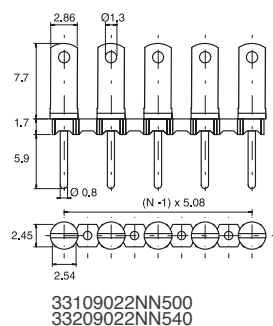

“U” PINS STRIP

STRIP TERMINALS COMPONENT SUPPORT STRIP



Version	P	nn	Plating	
			(a)	(b)
381 0435	1	20	500	Au
382 0435	1	20	540	Sn
383 0435	1	20	500	Au
384 0435	1	20	540	Sn
381 0559	1	20	501	Au
382 0559	1	20	541	Sn
381 0576	1	20	501	Au
382 0576	1	20	541	Sn

Product Code

A	B	C
xxxxxxx	1xx	5x0

A	Version, see table
B	Number of pins max
C	Plating 0 Gold 0.2 μm over Ni 1.27 μm 4 Tin 4 μm over Ni 1.27 μm

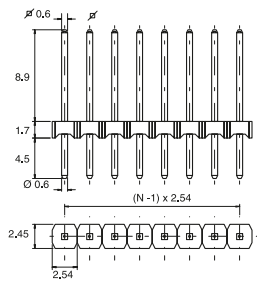

38104351NN500
38204351NN540

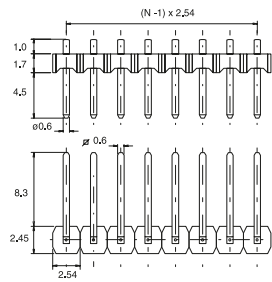

38304351NN500
38404351NN540

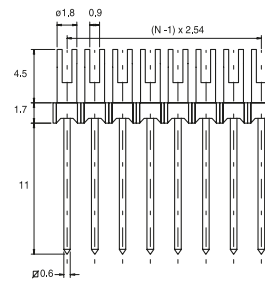

38X05761NN5X1

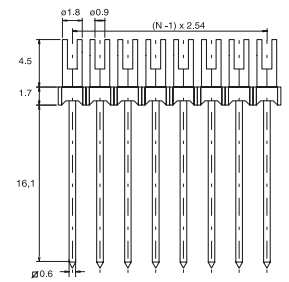

38X05591NN5X1

FEMALE TEST STRIP

STRIP TERMINALS FEMALE TEST STRIP TERMINALS STRIP



Version	P	nn	Plating	
			(a)	(b)
331 0599	1	20	400	Au
331 0222	1	20	400	Au
331 0216	1	20	400	Au

Product Code

A	B	C
xxxxxxx	1xx	5x0

A	Version, see table
B	Number of pins max
C	Plating 0 Gold 0.2 μm over Ni 1.27 μm

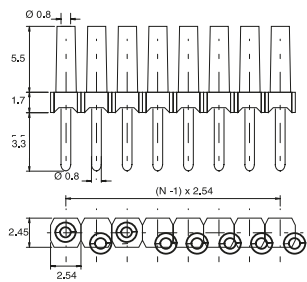

33105991NN400

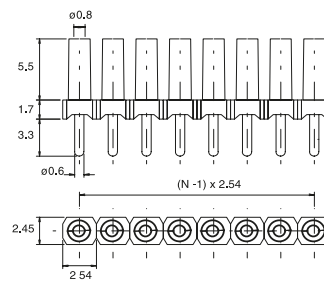

33102161NN400

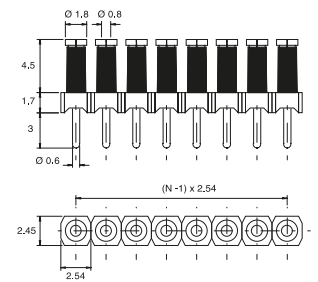

33102221NN400

FORK TERMINAL

TERMINAL PINS LOOSE FORK TERMINALS

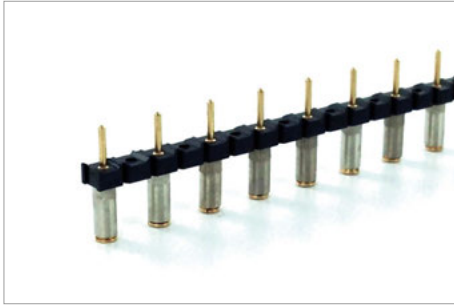

Product Code

A	B	C	D	E	F
xxx	xxxx	000	x	x	0

A Family

B Type of terminal pin

D Used material
(see references below)
2 Copper
4 Bronze
5 Brass

E Plating
0 Gold
0.2 μm over Ni 1.27 μm
4 Tin 5 μm over Ni 1.27 μm

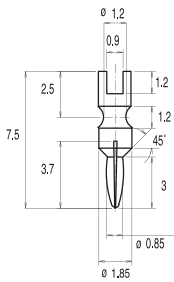

31112330005X0

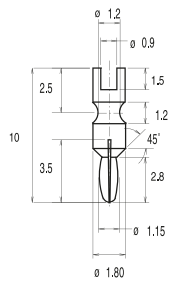

3101624000540

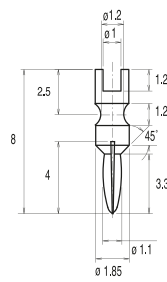

3111022000540

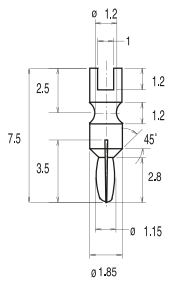

3101623000540

FORK TERMINAL

TERMINAL PINS LOOSE FORK TERMINALS



Product Code

A	B	C	D	E	F
xxx	xxxx	000	x	x	0

A Family

B Type of terminal pin

D Used material
(see references below)
2 Copper
4 Bronze
5 Brass

E Plating
0 Gold
0.2 μm over Ni 1.27 μm
4 Tin 5 μm over Ni 1.27 μm

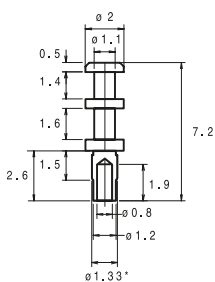

31100100005X0

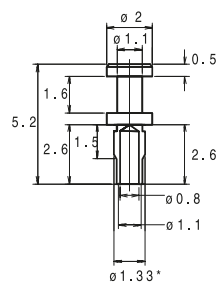

31100080005X0

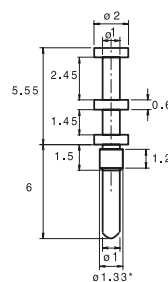

31100130005X0

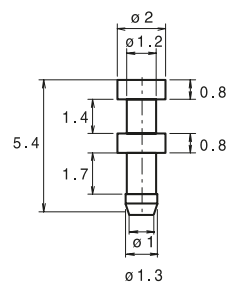

3110175000540

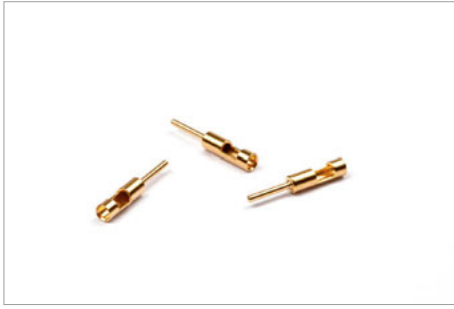

Product Code

A	B	C	D	E	F
xxx	xxxx	000	x	x	0

A	Family
B	Type of terminal pin
D	Used material (see references below) 2 Copper 4 Bronze 5 Brass

E	Plating 0 Gold 0.2 μm over Ni 1.27 μm 4 Tin 5 μm over Ni 1.27 μm
----------	---

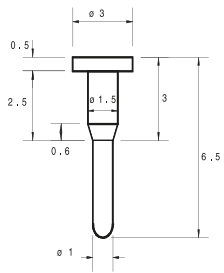

3103696000500

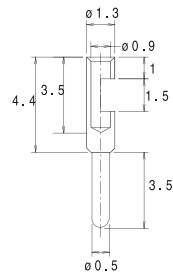

3120838000500

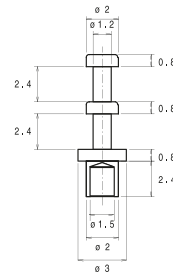

31100070005X0

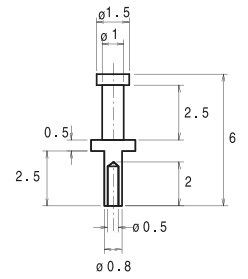

31103460005X0



Product Code

A	B	C	D	E	F
xxx	xxxx	000	x	x	0

A	Family	E	Plating 0 Gold 0.2 µm over Ni 1.27 µm 4 Tin 5 µm over Ni 1.27 µm
B	Type of terminal pin		
D	Used material (see references below) 2 Copper 4 Bronze 5 Brass		

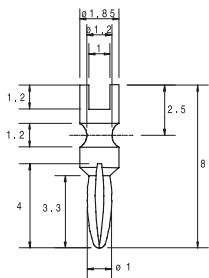

31110220005X0

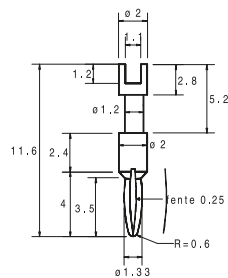

3101497000540

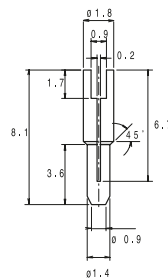

3110754000540

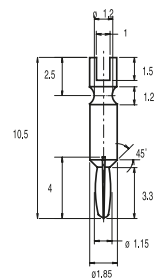

3101565000500

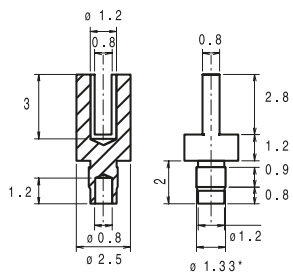

31101690005X0

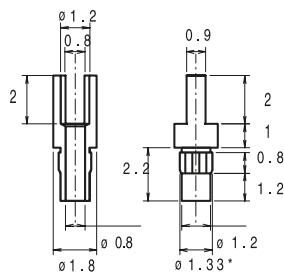

31100530005X0

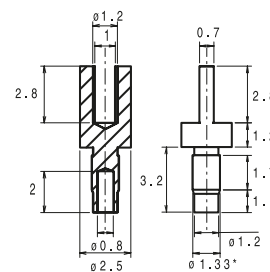

31100780005X0

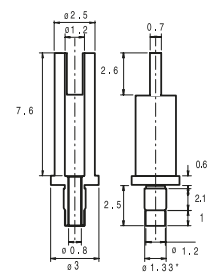

31100510005X0

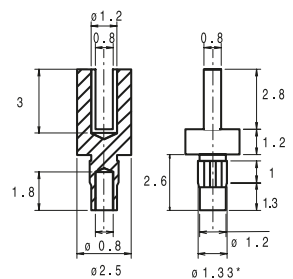

31100170005X0

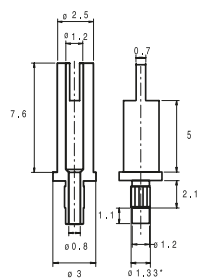

31100770005X0

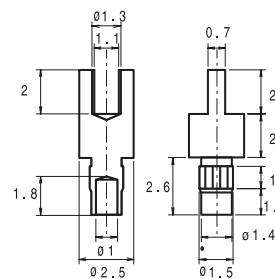

31100940005X0

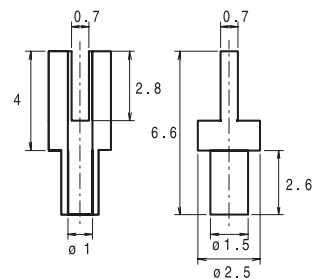

31101610005X0

*: Knurled



Product Code

A	B	C	D	E	F
xxx	xxxx	000	x	x	0

A	Family	E	Plating 0 Gold 0.2 μm over Ni 1.27 μm 4 Tin 5 μm over Ni 1.27 μm
B	Type of terminal pin		
D	Used material (see references below) 2 Copper 4 Bronze 5 Brass		

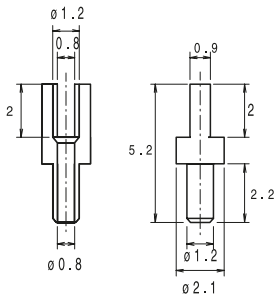

3110938000500

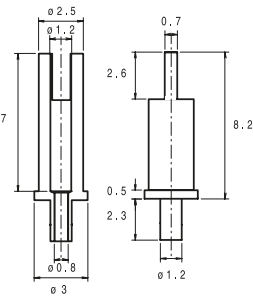
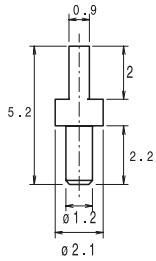

31102200005X0

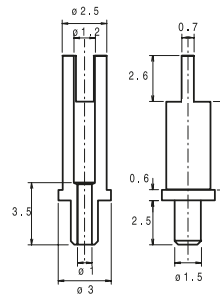

31100200005X0

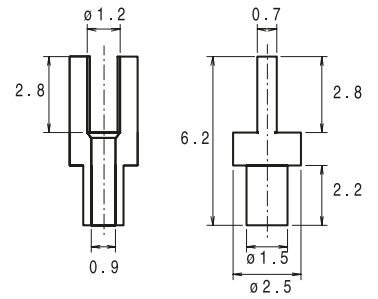

31100190005X0

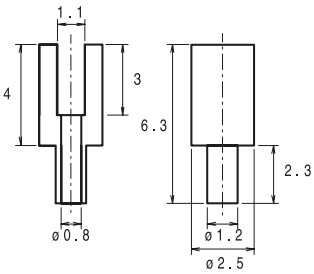

31103350005X0

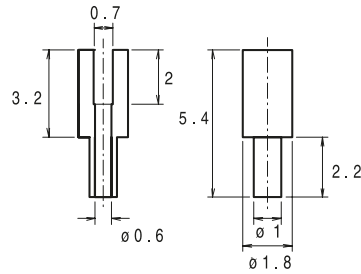

31101640005X0

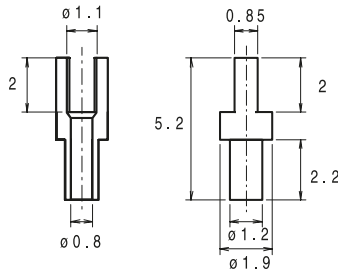

31102420005X0

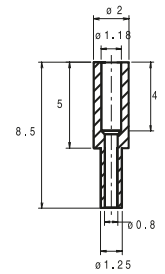

3130152000540

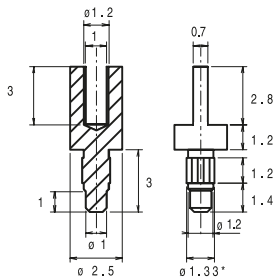

31100580005X0

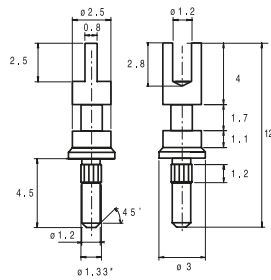

31103220005X0

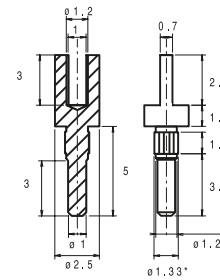

31100180005X0

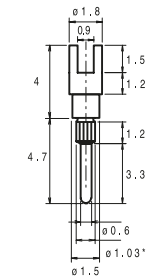

31108150005X0



Product Code

A	B	C	D	E	F
xxx	xxxx	000	x	x	0

A	Family	E	Plating 0 Gold 0.2 μm over Ni 1.27 μm 4 Tin 5 μm over Ni 1.27 μm
B	Type of terminal pin		
D	Used material (see references below) 2 Copper 4 Bronze 5 Brass		

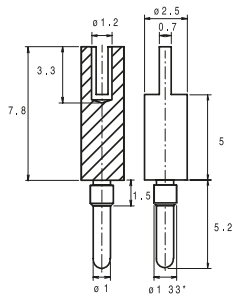

31100300005X0

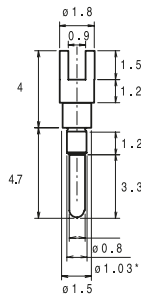

31106000005X0

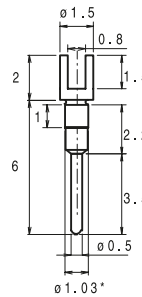

31107880005X0

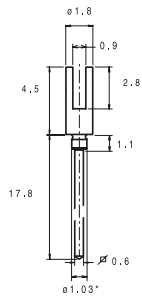

32405590005X0

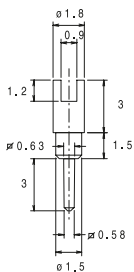

3111236000500

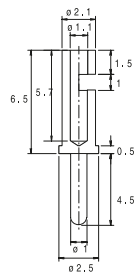

3120207000500

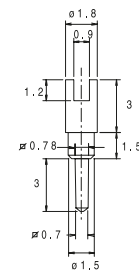

3111398000540

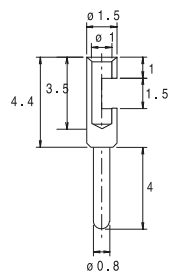

3120760000500

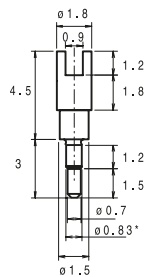

31112340005X0

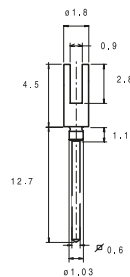

32405760005X0

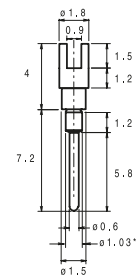

31108090005X0

FORK TERMINAL

TERMINAL PINS FORK TERMINAL



Product Code

A	B	C	D	E	F
xxx	xxxx	000	x	x	0

A	Family	E	Plating 0 Gold 0.2 μm over Ni 1.27 μm 4 Tin 5 μm over Ni 1.27 μm
B	Type of terminal pin		
D	Used material (see references below) 2 Copper 4 Bronze 5 Brass		

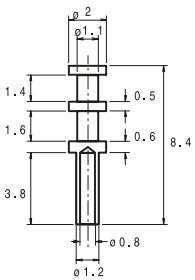

31103440005X0

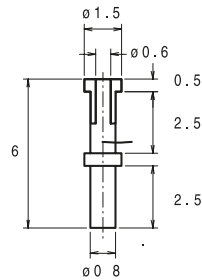

31101650005X0

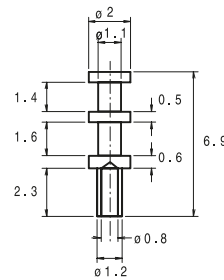

31103250005X0

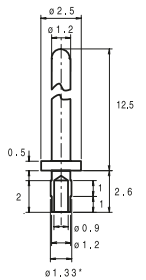

3130356000500

MALE TEST TERMINAL

TERMINAL PINS LOOSE MALE TEST TERMINALS



Product Code

A	B	C	D	E	F
xxx	xxxx	000	x	x	0

A	Family	E	Plating 0 Gold 0.2 μm over Ni 1.27 μm 4 Tin 5 μm over Ni 1.27 μm
B	Type of terminal pin		
D	Used material (see references below) 2 Copper 4 Bronze 5 Brass		

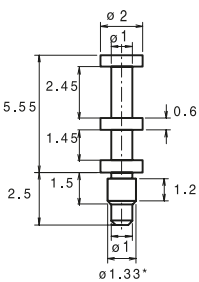

31100140005X0

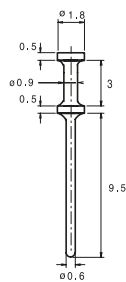

3110190000540

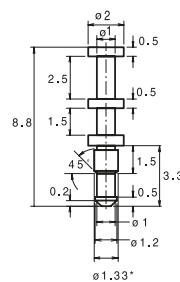

31100250005X0

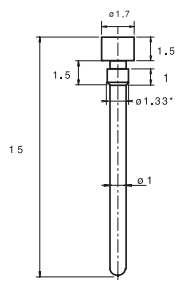

3102840000540

*: Knurled



Product Code

A	B	C	D	E	F
xxx	xxxx	000	x	x	0

A	Family
B	Type of terminal pin
D	Used material (see references below) 2 Copper 4 Bronze 5 Brass

E	Plating 0 Gold 0.2 µm over Ni 1.27 µm 4 Tin 5 µm over Ni 1.27 µm
----------	---

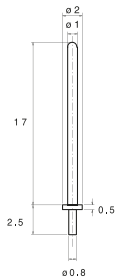

31300880005X0

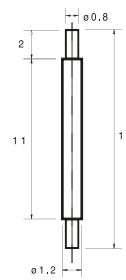

31300490005X0

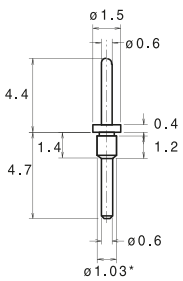

3120219000500

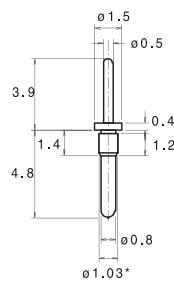

3120299000500

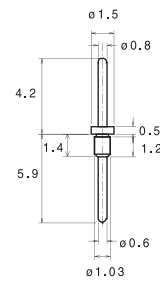

3101939000500

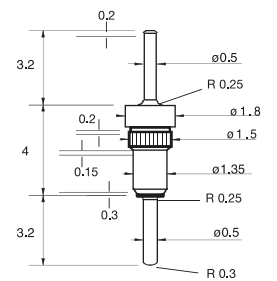

31203180005X0



Product Code

A	B	C	D	E	F
xxx	xxxx	000	x	x	0

A	Family	E	Plating 0 Gold 0.2 μm over Ni 1.27 μm 4 Tin 5 μm over Ni 1.27 μm
B	Type of terminal pin		
D	Used material (see references below) 2 Copper 4 Bronze 5 Brass		

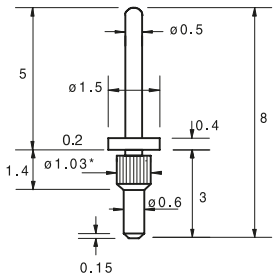

3102310000500

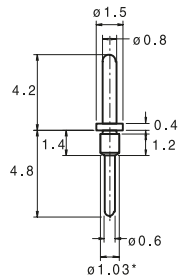

3120778000500

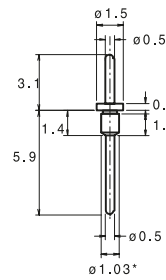

3121594000500

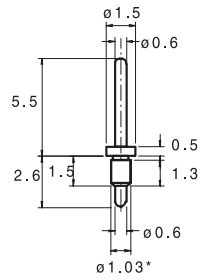

31202120005X0

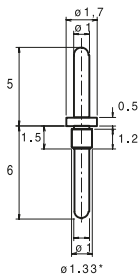

31200150005X0

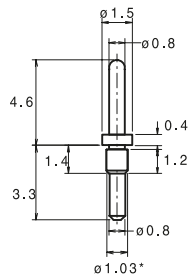

3121017000500

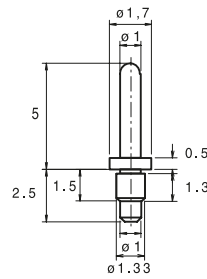

3120016000500

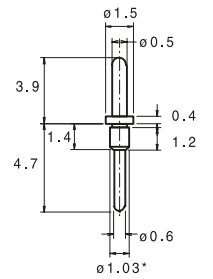

3120300000500



Product Code

A	B	C	D	E	F
xxx	xxxx	000	x	x	0

A	Family	E	Plating 0 Gold 0.2 µm over Ni 1.27 µm 4 Tin 5 µm over Ni 1.27 µm
B	Type of terminal pin		
D	Used material (see references below) 2 Copper 4 Bronze 5 Brass		

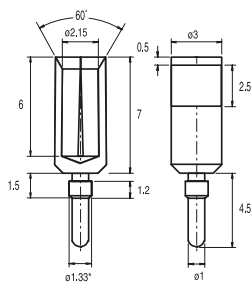

Pin ø: 2
3120382000400

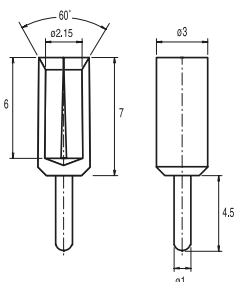

Pin ø: 2
3102957000500

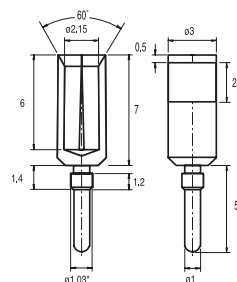

Pin ø: 2
3122056000400

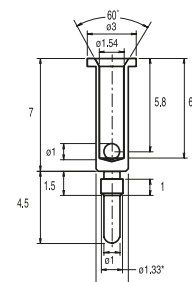

3121350000500

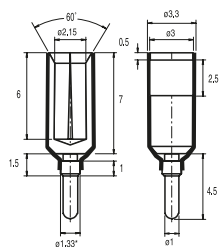

Pin ø: 2
312038300040Y

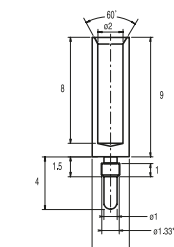

Pin ø: 2
3120598000500

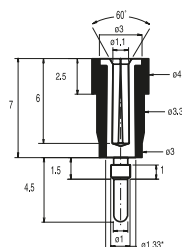

Pin ø: 1
312003400040Y

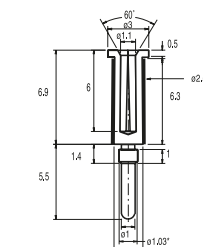

3120223000400

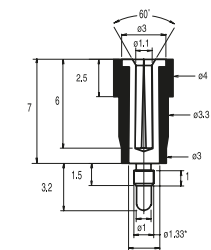

Pin ø: 1
312113900040Y

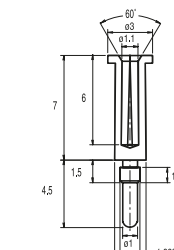

Pin ø: 1
3120032000400

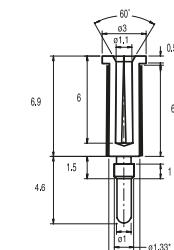

Pin ø: 1
3121168000400

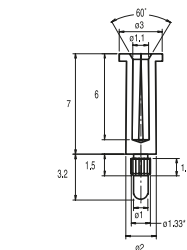

Pin ø: 1
3120079000400



Product Code

A	B	C	D	E	F
xxx	xxxx	000	x	x	0

A	Family
B	Type of terminal pin
D	Used material (see references below) 2 Copper 4 Bronze 5 Brass

E	Plating 0 Gold 0.2 µm over Ni 1.27 µm 4 Tin 5 µm over Ni 1.27 µm
----------	---

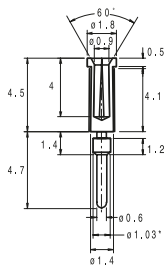

Pin ø: 0.8

3120222000400

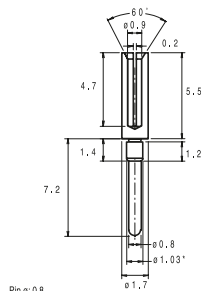

Pin ø: 0.8

3120668000400

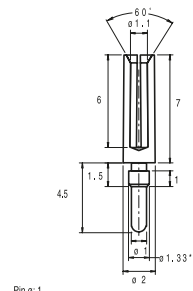

Pin ø: 1

3120266000400

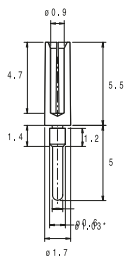

Pin ø: 0.8

3120216000400

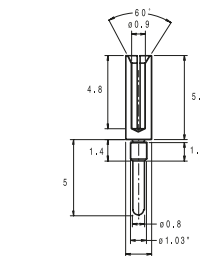

Pin ø: 0.8

3120599000400

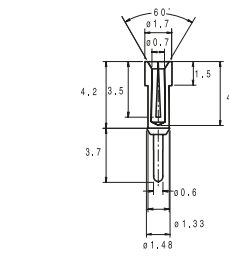

Pin ø: 0.6

3120218000400

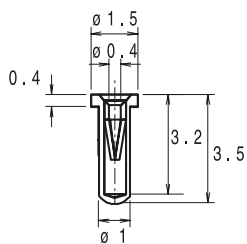

Pin ø: 0.5

3121896000440

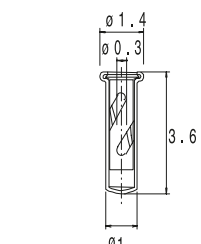

Pin ø: 0.4

3120128000400

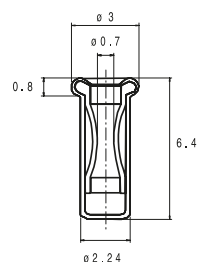

Pin ø: 0.45

31203850002X0



Product Code

A	B	C	D	E	F
313	xxxx	000	5	x	0

B Type of jumper

Plating

0 Gold

E 0.2 μm over Ni 1.27 μm
 4 Tin 5 μm over copper 3 μm
 Material: brass

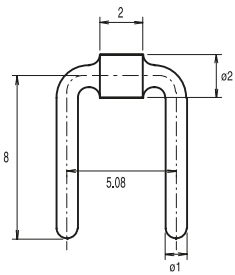

31300050005X0

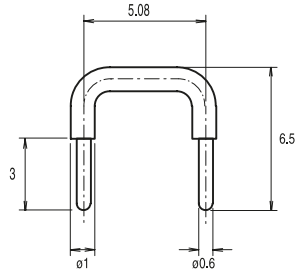

31305820005X0

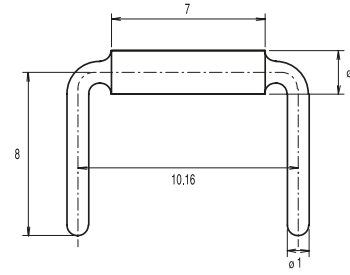

31300040005X0

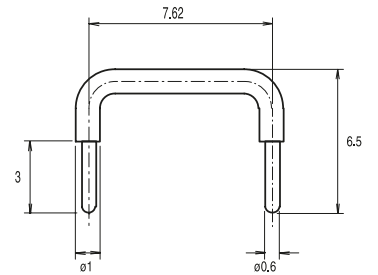

31305780005X0

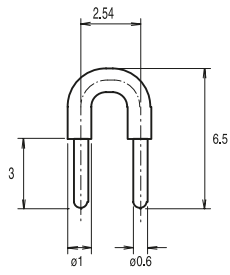

31305810005X0

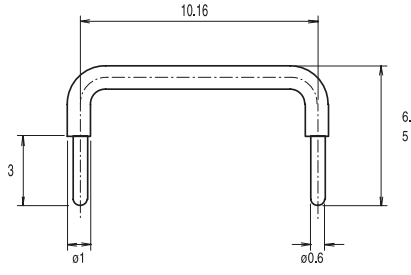

31305790005X0

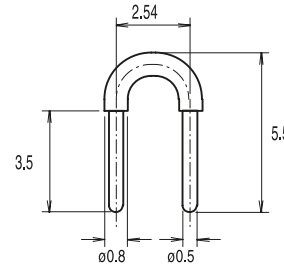

31308260005X0

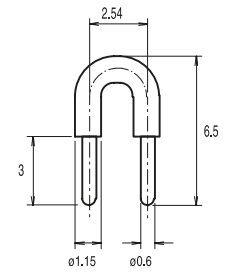

31025970005X0

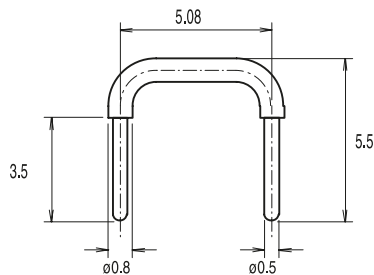

31308270005X0

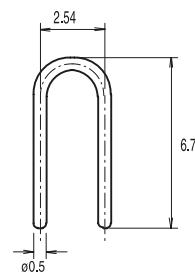

3130777000500

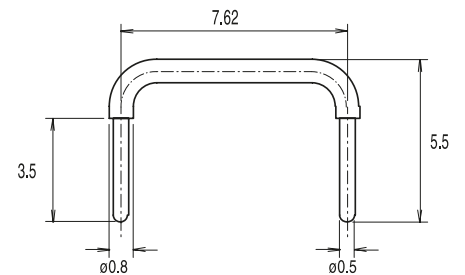

3130828000500



Product Code

A	B	C	D	E	F
313	xxxx	000	5	x	0

B	Type of jumper
E	Plating 0 Gold 0.2 µm over Ni 1.27 µm 4 Tin 5 µm over copper 3 µm Material: brass

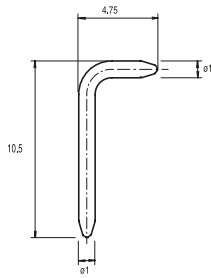

31304990005X0

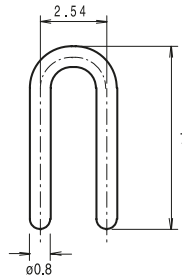

31306810005X0

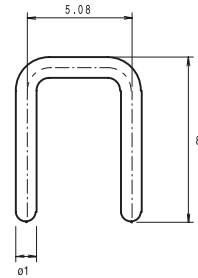

31305230005X0

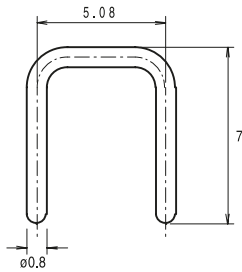

31306750005X0

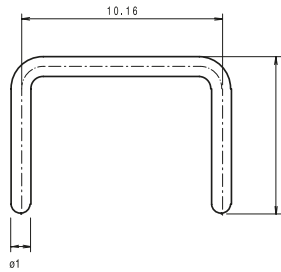

31305240005X0

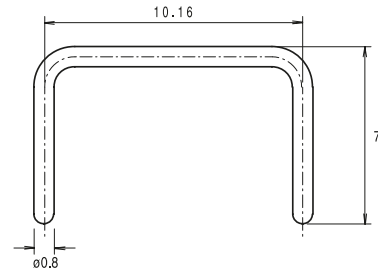

31306760005X0

REFERENCE	PAGE
331 0299 1xx 5x0	1
331 0219 1xx 5x0	1
331 0300 1xx 5x0	1
331 0416 1xx 5x0	1
331 0778 1xx 5x0	1
331 1594 1xx 5x0	1
332 0219 1xx 5x0	1
332 0299 1xx 5x0	1
332 0300 1xx 5x0	1
332 0416 1xx 5x0	1
332 0778 1xx 5x0	1
332 1594 1xx 5x0	1
333 1594 1xx 5x0	1
334 1594 1xx 5x0	1
331 0600 1xx 5x0	2
331 0600 1xx 5x0	2
331 0809 1xx 5x0	2
331 0815 1xx 5x0	2
331 0902 1xx 5x0	2
331 1422 1xx 5x0	2
332 0600 1xx 5x0	2
332 0600 1xx 5x0	2
332 0809 1xx 5x0	2
332 0815 1xx 5x0	2
332 0902 1xx 5x0	2
332 1422 1xx 5x0	2
333 0902 1xx 5x0	2
334 0902 1xx 5x0	2
331 0216 1xx 5x0	3
331 0222 1xx 5x0	3
331 0599 1xx 5x0	3
381 0435 1xx 5x0	3
381 0559 1xx 5x0	3
381 0576 1xx 5x0	3
382 0435 1xx 5x0	3
382 0559 1xx 5x0	3
382 0576 1xx 5x0	3
383 0435 1xx 5x0	3
384 0435 1xx 5x0	3
310 1623 000 540	4
310 1624 000 540	4
311 0008 000 5x0	4
311 0010 000 5x0	4
311 0013 000 5x0	4
311 0175 000 5x0	4
311 1022 000 540	4
311 1233 000 5x0	4
310 3696 000 500	4
311 0007 000 5x0	4

sommaire

310 1497 000 5x0	5
310 1565 000 5x0	5
311 0017 000 5x0	5
311 0051 000 5x0	5
311 0053 000 5x0	5
311 0077 000 5x0	5
311 0078 000 5x0	5
311 0094 000 xx0	5
311 0161 000 xx0	5
311 0169 000 5x0	5
311 0754 000 5x0	5
311 1022 000 5x0	5
311 0018 000 5x0	6
311 0019 000 5x0	6
311 0020 000 5x0	6
311 0058 000 5x0	6
311 0161 000 5x0	6
311 0242 000 5x0	6
311 0322 000 5x0	6
311 0326 000 5x0	6
311 0335 000 5x0	6
311 0815 000 5x0	6
311 0938 000 5x0	6
311 0030 000 5x0	7
311 0600 000 5x0	7
311 0788 000 5x0	7
311 1234 000 5x0	7
311 1398 000 5x0	7
312 0207 000 xxx	7
312 0760 000 xxx	7
324 0559 000 5x0	7
310 2840 000 5x0	8
311 0014 000 5x0	8
311 0025 000 5x0	8
311 0165 000 5x0	8
311 0190 000 5x0	8
311 0325 000 5x0	8
311 0344 000 5x0	8
313 0356 000 5x0	8
310 1555 000 5x0	9
310 3688 000 5x0	9
311 0254 000 5x0	9
311 0323 000 5x0	9
311 0902 000 5x0	9
311 1331 000 5x0	9
311 1607 000 5x0	9
310 1939 000 5x0	10
312 0219 000 xxx	10
312 0299 000 xxx	10
312 0318 000 xxx	10

sommaire

310 2310 000 5x0	11
312 0015 000 xxx	11
312 0016 000 xxx	11
312 0300 000 xxx	11
312 0778 000 xxx	11
312 1017 000 xxx	11
312 1594 000 xxx	11
312 0034 000 xxx	12
312 0037 000 xxx	12
312 0079 000 xxx	12
312 0223 000 xxx	12
312 0382 000 xxx	12
312 0383 000 xxx	12
312 0598 000 xxx	12
312 1139 000 xxx	12
312 1168 000 xxx	12
312 1350 000 xxx	12
312 2056 000 xxx	12
312 0128 000 xxx	13
312 0216 000 xxx	13
312 0218 000 xxx	13
312 0222 000 xxx	13
312 0266 000 xxx	13
312 0385 000 xxx	13
312 0599 000 xxx	13
312 1896 000 xxx	13
310 2597 000 5x0	14
313 0004 000 5x0	14
313 0005 000 5x0	14
313 0578 000 5x0	14
313 0579 000 5x0	14
313 0581 000 5x0	14
313 0582 000 5x0	14
313 0777 000 5x0	14
313 0826 000 5x0	14
313 0827 000 5x0	14
313 0828 000 5x0	14
313 0499 000 5x0	15
313 0523 000 5x0	15
313 0675 000 5x0	15
313 0676 000 5x0	15
313 0681 000 5x0	15

IEC 60335-1 SAFETY OF HOUSEHOLD AND SIMILAR ELECTRICAL APPLIANCES

This Standard deals with the safety of electrical appliances for household and similar purposes; the rated voltage of the appliances being not more than 250 V for single-phase appliances and 480 V for other appliances. Recently the Standard has been modified and requirements are reportedly much stricter than those previously used, in order to avoid fire risks and provide further guarantees of safety in electrical appliances. Such modifications involve, above all, components made of an insulating material that support electrical connections carrying a current > 0.2 A, including components at a distance of less than 3 mm from the connection. The flowchart for the material and / or part evaluation according to IEC 60335-1 is schematically illustrated in figure.

PARAGRAPH 30 - RESISTANCE TO HEAT AND FIRE

30.1 - Heat resistance

The parts must comply with the Ball Pressure Test (IEC 60695-10-2). The test is carried out at a temperature of 40 °C ± 2 °C plus the maximum temperature rise determined during the test of clause 11, but it shall be at least 75 °C ± 2 °C for external components and 125 °C ± 2 °C for components supporting live parts.

30.2 - Fire resistance

30.2.2 - Attended Appliances

According to the Standard, parts ought to be subjected to the Glow-Wire Test (IEC 60695-2-11), which is carried out at 750 °C for connections that carry a current > 0.5 A and 650 °C for other connections.

30.2.3 - Unattended Appliances

30.2.3.1: Parts that carry a current > 0.2 A shall have a Glow Wire Flammability Index (GWFI) > = 850 °C (IEC 60695-2-12).

30.2.3.2: parts supporting current/carrying connections shall always be subjected to the Glow-Wire Test according

to IEC 60695-2-11. However, the GWT is not carried out on parts of material classified as having a Glow-Wire Ignition Temperature (GWIT—according to IEC 60695-2-13) of > = 775 °C for connections that carry a current > 0.2A, and > = 675 °C for other connections.

Test samples have to be no thicker than the relevant part. The maximum flame-persistence time admitted during the test is of 5 seconds.

When the Glow-Wire Test of IEC 60695-2-11 is carried out on the parts, the temperatures are of 750 °C for connections which carry a current > 0.2 A and 650 °C for lower connections. If during the test a flame that persists for longer than 2 seconds is produced, the Needle-Flame Test must be carried out for all parts above the connection within the envelope of a vertical cylinder having a diameter of 20 mm and a height of 50 mm. However, the latter test is not needed if between the connections and the other parts there is a «protection» that comply with the Needle-Flame Test.

The Needle-Flame Test is not carried out on parts of material classified as V-0 or V-1 (IEC 60695-11-10), provided that the test sample was no thicker than the relevant part.

WÜRTH ELEKTRONIK STELVIO KONTEK is able to provide both standard version components and special version components complying with IEC 60335-1, as shown in selection tables of each section. In your purchase order, if you require the latter type of product, you can simply add “GWT” at the end of the standard code.

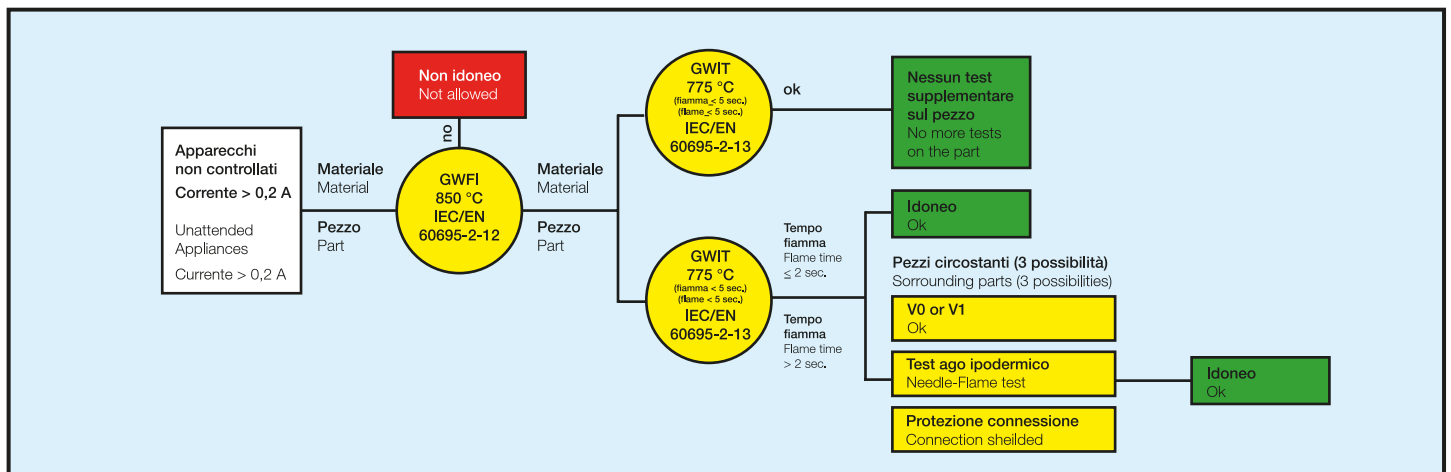
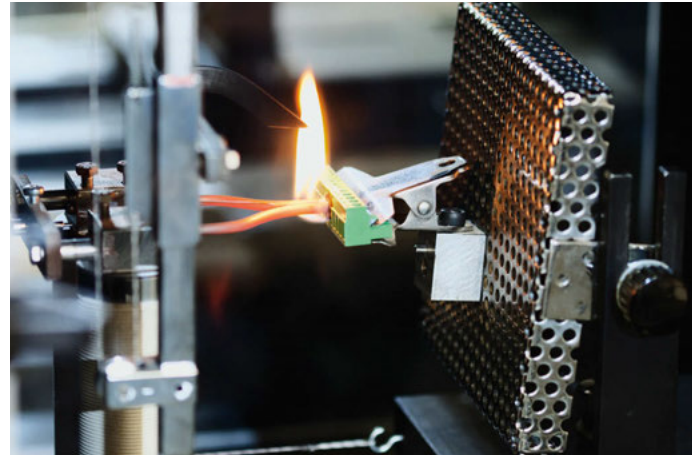

CERTIFICATIONS & HOMOLOGATIONS

For us Kontek Kontek, quality is a concrete result rather than a merely formal value. Our ranges comply with European Directives in safeguarding environment (RoHS, WEEE, PFOS, REACH, etc.). The Oggiono plant is ISO 9001 certified since 1995; the Romanian plant since 2012.



INTERNATIONAL STANDARDS



EUROPEAN DIRECTIVES





PHILOSOPHY & VALUES

Responsibility with a big R

Focus on the Human foremost

Kontek Kontek truly believe that corporate culture cannot endure without partnership and trust, either towards collaborators or partners and customers. Hence we take great care in optimizing our communication channels and define common win-win objectives. After all, best ideas necessarily come from individual.



Eco-responsibility

An investment on our future

For us environmental responsibility doesn't only mean being green. It has to be a real and true doctrine flowing through all capillaries of our organization.

Thus, thanks to its Environmental Management System with ISO 14001 certification and its strong spirit of innovation, the group makes its own contribution to defending the environment as one of its top priorities through sustainable development: industrial wastewater is conditioned, air is protected with "end of pipe scrubbers", chemical substances are stocked in "double-jacket" tanks and the natural resources consumption is carefully monitored.



Global Compact

A human face to the global market

The United Nations Global Compact is a call to companies everywhere to voluntarily align their operations and strategies with ten universally-accepted principles in the areas of human rights, labour, environment and anti-corruption, and to take action in support of UN goals, including the Millennium Development Goals.

Würth Elektronik Stelvio Kontek agrees on and takes part in the UN Global Compact platform for the development, implementation, and disclosure of responsible corporate policies and practices. Launched in 2000, it is the largest corporate responsibility initiative in the world, with over 10,000 signatories based in 140 countries.

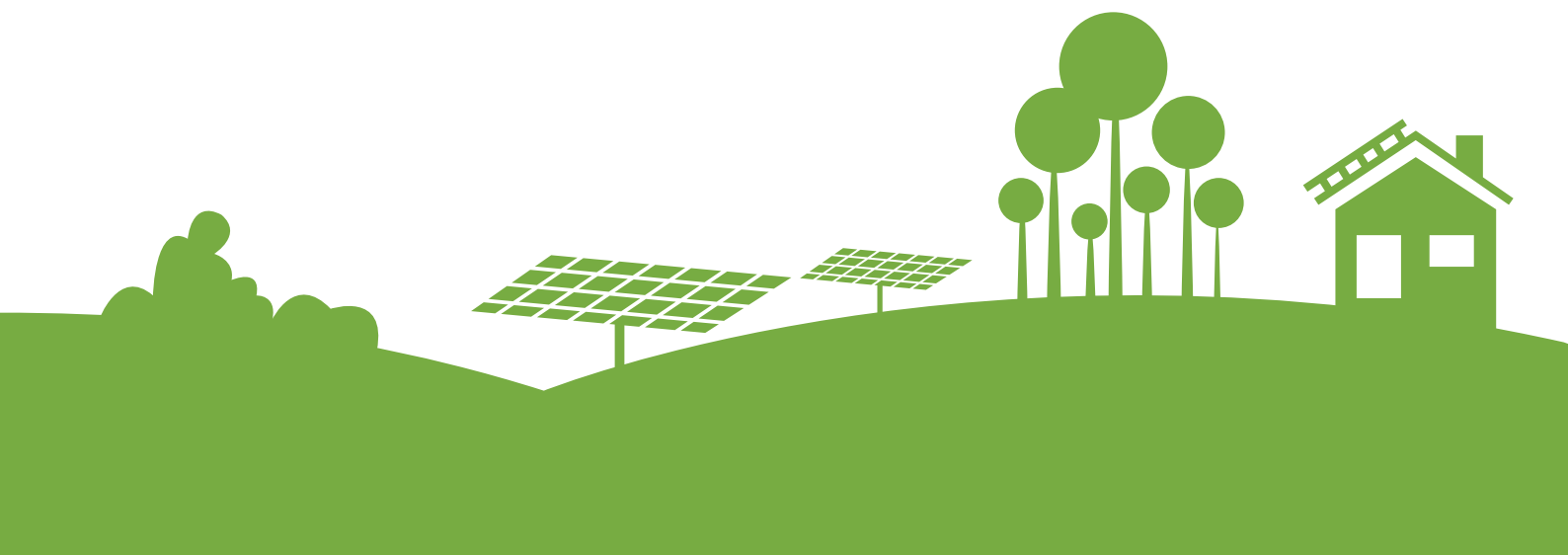



AA2DE

K KONTEK
COMATEL
ELECTRONIQUE CONNECTORS MANUFACTURING

France

AA2DE

3, RUE CHATLES BEAUVAIS ZAC
DE LA FOSSE AUX MOINES 94864
BONNEUIL SUR MARNE

Commercial France

Tel : 00 33 1 56 71 26 55

Fax : 00 33 1 43 77 52

E-mail : aa2de@club-internet.fr



watch the video

